

To continue its program of quality and design improvement, the manufacturer reserves the right to change specifications, designs or prices without notice and without incurring obligation.

GRAVELY
 ILLUSTRATED
Parts and Price List
 PRINTED IN U. S. A.

SWIFT-A-MATIC TRANSMISSION

Model Nr. _____
 Effective Date: 8-1-63
 Form Number: PPL-130

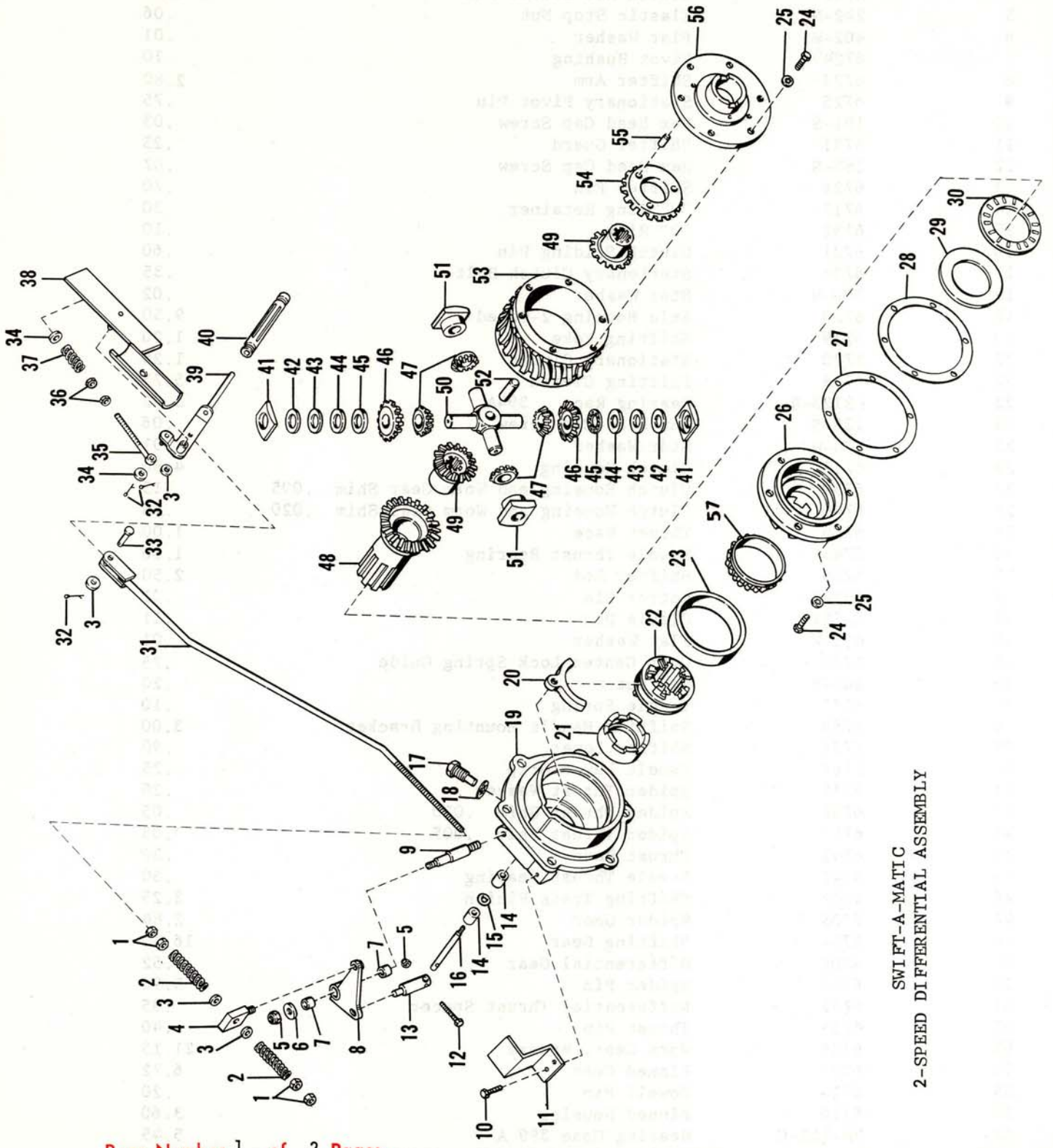

SWIFT-A-MATIC
 2-SPEED DIFFERENTIAL ASSEMBLY

SWIFT-A-MATIC
2-SPEED DIFFERENTIAL ASSEMBLY

Item No.	Part No.	Description	Price
1	204-N	Hex Nut	.02
2	6750	Spring	.20
3	403-W	Clutch Spring Washer	.01
4	6760	Clutch Rod Swivel Pin	1.60
5	242-N	Elastic Stop Nut	.06
6	402-W	Flat Washer	.01
7	6724	Pivot Bushing	.10
8	6723	Shifter Arm	2.80
9	6725	Stationary Pivot Pin	.75
10	191-S	Hex Head Cap Screw	.03
11	6731	Shifter Guard	.25
12	185-S	Hex Head Cap Screw	.07
13	6726	Shifter Pin	.70
14	6713	"O" Ring Retainer	.30
15	6732	"O" Ring	.10
16	6721	Clutch Sliding Pin	.60
17	6734	Stationary Clutch Bolt	.35
18	309-W	Star Washer	.02
19	6728	Axle Housing 2-Speed	9.50
20	6719	Shifting Yoke	1.20
21	6720	Stationary Clutch	1.25
22	6718	Shifting Clutch	5.75
23	RB123-R	Bearing Race 394A	3.42
24	139-S	Hex Head Cap Screw	.06
25	304-W	Star Washer	.01
26	6717	Clutch Housing	4.80
27	6739	Clutch Housing and Worm Gear Shim .005	.15
28	6740	Clutch Housing and Worm Gear Shim .020	.25
29	6744	Thrust Race	1.00
30	6743	Needle Thrust Bearing	1.00
31	6758	Shifter Rod	2.50
32	602-C	Cotter Pin	.01
33	L-722	Clevis Pin	.11
34	401-W	Flat Washer	.01
35	6757	Over Center Lock Spring Guide	.75
36	201-N	Hex Nut	.20
37	6755	Toggle Spring	.10
38	6759	Shifting Handle Mounting Bracket	3.00
39	6756	Shifter Lever	.90
40	5167	Handle Lever Grip	.25
41	6715	Spider Thrust Washer	.20
42	6738	Spider Thrust Shim .020	.05
43	6737	Spider Thrust Shim .005	.05
44	6742	Thrust Race	.30
45	6741	Needle Thrust Bearing	.50
46	6702	Shifting Train Pinion	3.25
47	6708	Spider Gear	2.84
48	6704	Shifting Gear	16.40
49	6709	Differential Gear	5.52
50	6710	Spider Pin	5.96
51	6752	Differential Thrust Spacer	.35
52	6711	Thrust Pin	.40
53	6705	Worm Gear, Bronze	21.15
54	6703	Pinned Gear	6.72
55	6714	Dowell Pin	.20
56	6716	Pinned Housing	3.60
57	RB-123-C	Bearing Cone 399 A	5.45
	NN	Shifter Rod Assembly, Complete	11.25