

# GRAVELY STEERING SULKY

ILLUSTRATED PARTS AND PRICE LIST

PRICES SUBJECT TO CHANGE WITHOUT NOTICE

KEY: NS-NOT SHOWN NN-NO PART NUMBER

ORDER BY DESCRIPTION

EFFECTIVE AUGUST 1, 1957



## PLATE A

PHOTO NO.	PART NO.	DESCRIPTION	PRICE
1	A-443-12	Seat	\$2.28
2	211-N	Seat Nut	.04
3	180-S	Seat Bolt	.09
4	A-443-10	Seat Spring	4.37
5	A-320WH	Wheels	13.53
	A-320-TI	Tires	7.50
	A-320-TU	Tubes	2.78
	A-320-RI	Rims	6.24

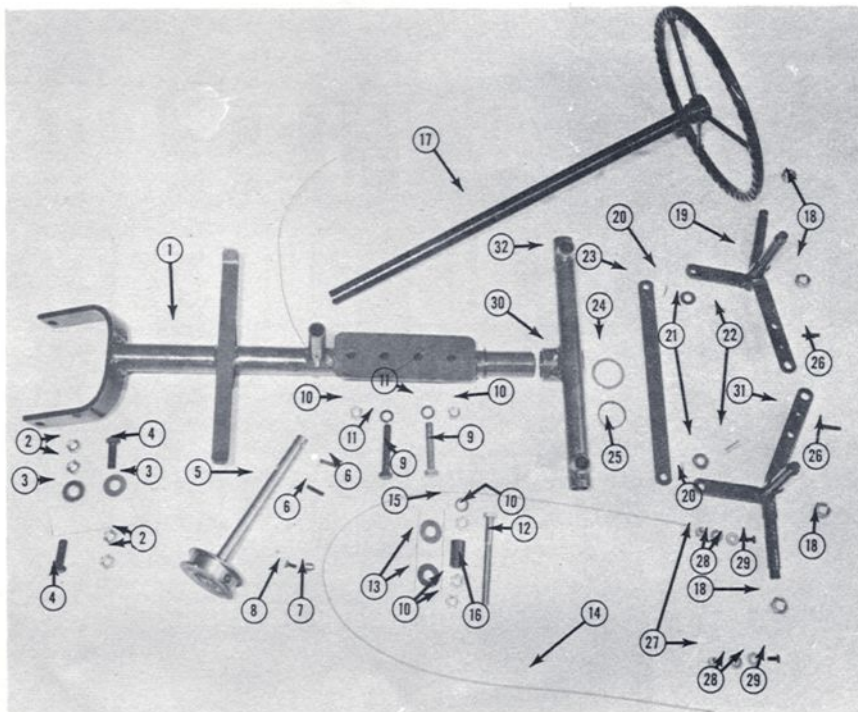
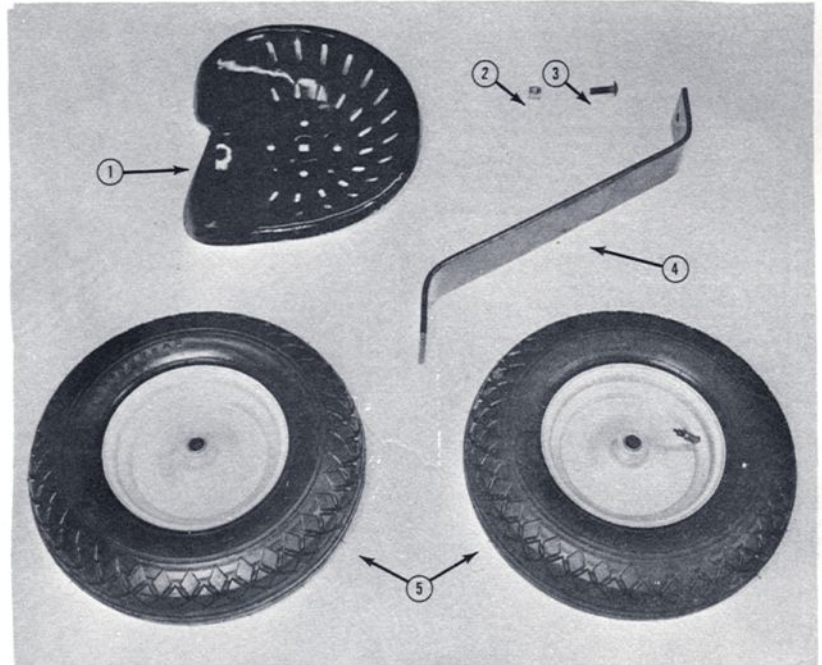

## PLATE B

PHOTO NO.	PART NO.	DESCRIPTION	PRICE
1	SS-101	Sulky Chassis Welded Frame	\$9.35
2	210-N	Fork End Rear Hitch Jam Nuts	.04
3	410-W	Fork End Bolt Washer	.01
4	173-S	Fork End Rear Hitch Bolts	.11
5	SS-102	Cable Reel	4.18
6	HE-104	Cable Reel Rollpins	.09
7	SS-111	Reel Nipple	.33
8	175-S	Reel Nipple Bolt	.01
9	172-S	Seat Spring Draw Bar Bolts	.18
10	211-N	Spring Bolt & Guide Roller Bolt Nuts	.04
11	308-W	Seat Spring Draw Bar Bolt Lk. Wash.	.01
12	116-S	Guide Roller Bolt	.22
13	410-W	Guide Roller Washer	.01
14	SS-113	Steering Cable	2.75
15	308-W	Guide Roller Bolt Lock Washer	.01
16	SS-107	Guide Roller	.33
17	SS-106	Steering Wheel & Column Assy.	6.93
	SS-106-B	Steering Wheel Only	5.39
18	227-N	Axle and King Pin Nuts	.23
19	SS-105	Right Axle and King Pin Assembly	6.38
20	602-C	Cotter Pins, use with L-722	.01
21	403-W	Washers, use with L-722	.01
22	L-722	Clevis Pins	.11
23	SS-108	Tie Bar	.88
24	SS-112	Thrust Washer	.08
25	RR-111	Retaining Ring	.28
26	HE-104	Axle and King Pin Assy. Rollpins	.09
27	214-N	Cable Nut	.02
28	401-W	Not Used	
29	175-S	Not Used	
30	904-G	Grease Fittings	.11
31	SS-104	Left Axle and King Pin Assembly	6.38
32	SS-103	Cross Pipe Welded Assembly	7.59
NS	SS-114	Swivel Bracket	.33
NS	SS-115	Swivel Pin	.11
NS	606-C	Swivel Pin Cotter Pin	.01
NS	SS-116	Nipple Plug	.02
NS	HE-107	Roll Pin, Long	.09
NS	411-W	Seat Spring Washer	.01